

GENERAL SPECIFICATIONS:

- 16 Gauge #304 Stainless Steel Countertop
- 6" Casters, Two (2) Rigid and Two (2) Swivel with Brakes
- Black Rubber Caster Skirt on Three (3) Sides
- Hand Sink with Removable Water Tanks
- Locking Storage Compartment
- Black Vinyl Bumper on Three (3) Sides
- Knock Box

OPTIONS:

- Custom Exterior Panels (Laminate, Graphics, Powdercoat, Etc.)
- Track Lights
- Cart Cover

EQUIPMENT:

- Undercounter Refrigerator
- Espresso Machine (By Others)
- Water Filter

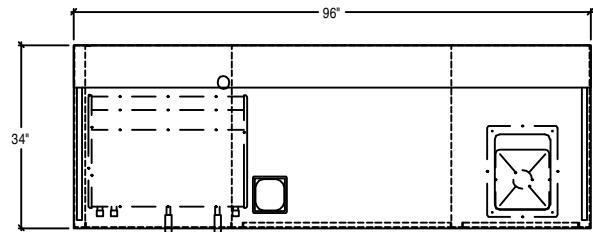

AWNING TYPES:

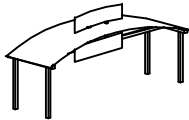

■ The Arch

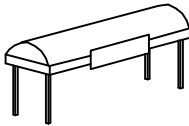

■ The Barrel

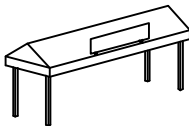

■ The A-Frame



■ The Halo



■ The Square

